

## REMOVAL

1. DRAIN ENGINE COOLANT
2. REMOVE AIR CLEANER INLET
3. REMOVE AIR CLEANER AND MAF METER ASSEMBLY
4. REMOVE ELECTRIC COOLING FAN
  - (a) Disconnect the upper radiator hose from the radiator.
  - (b) Disconnect the ECM outlet duct from the ECM box.
  - (c) Disconnect the wire for electric cooling fan from the clamp on the electric cooling fan.
  - (d) Disconnect the 2 electric cooling fan connector.
  - (e) Disconnect the radiator reservoir hose from the radiator.

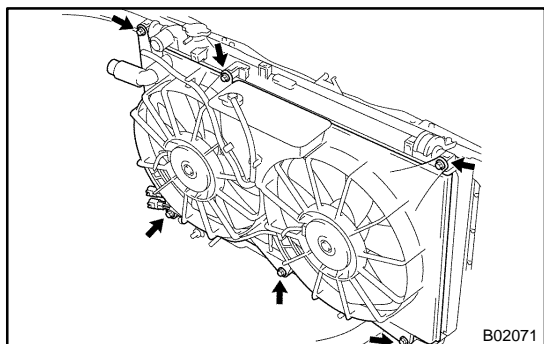

- (f) Remove the 6 bolts and electric cooling fan.